

ROHS

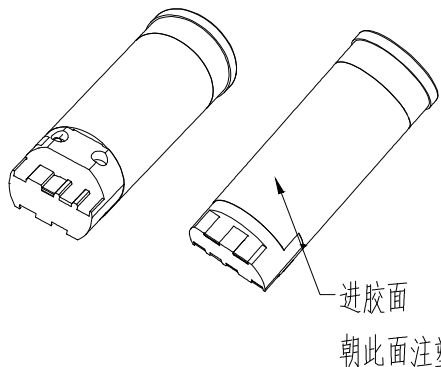

Circuit Diagram

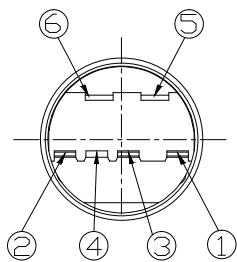
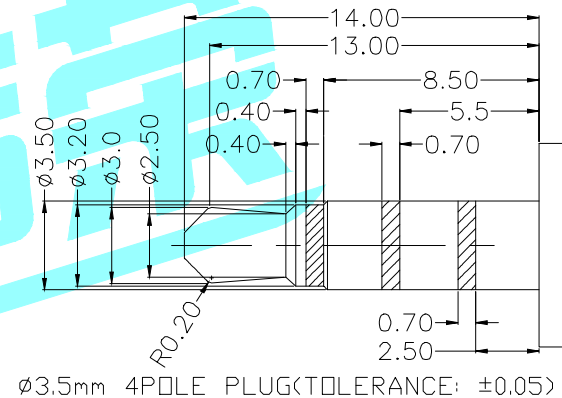
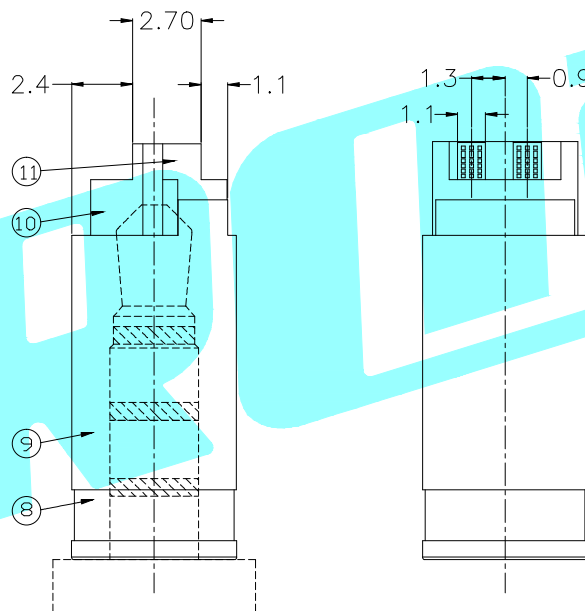
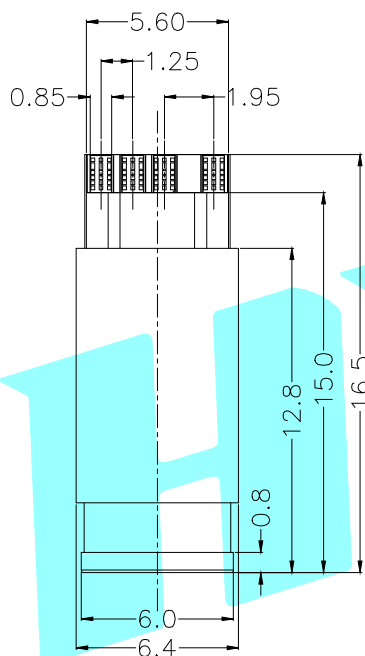
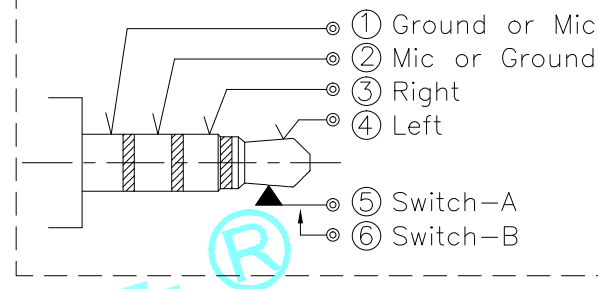

ø3.5mm 4POLE PLUG(TOLERANCE: ±0.05)

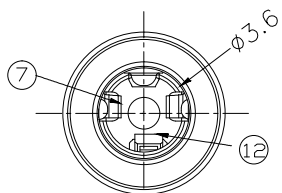

Rating:1A 12V DC  
 Contact Resistance:100 mΩ Max.  
 Operating temperature:-25℃~85℃  
 Operating force:30N Min  
 Operating Life:5,000cycles

⑫	Separator	—	1	Thermoplastics	White	—
⑪	Cover2	—	1	Thermoplastics	White	—
⑩	Cover1	—	1	Thermoplastics	White	—
⑨	Housing	—	1	Thermoplastics	White	—
⑧	Sleeve	—	1	Copper Alloy	Ni Plating	—
⑦	Spring Contact	—	1	Copper Alloy	Ni Plating	—
⑥	Switch B Contact	—	1	Copper Alloy	Ni Plating	—
⑤	Switch A Contact	—	1	Copper Alloy	Ni Plating	—
④	Left Contact	—	1	Copper Alloy	Ni Plating	—
③	Right Contact	—	1	Copper Alloy	Ni Plating	—
②	Mic Contact	—	1	Copper Alloy	Ni Plating	—
①	Ground Contact	—	1	Copper Alloy	Ni Plating	—
ITEM	PART NAME	TER'NO.	QTY.	MATERIAL	FINISHING	REMARK

APPROVALS		DATE		 ELECTRONICS CO.,LTD			
DRAWN	J.X.Zhang	2019/8/8					
CHECKED				TITLE:	PHONE JACKES		
APPROVALS				PART NO.	PJ-618		
TOLERANCES ARE			30~以上 10~30 5~10 ~ 5	±0.30 ±0.20 ±0.15 ±0.10	ANGLE	UNIT: mm	
ECN NO.	REV.	DATE.	DESCRIPTION.	CHANGE.	CHECK.	APPRO.	SCALE: 1:1
							PROJ:
							DRAWING NO.
							SHEET 1 OF 1

—	A	—	NEW	—	—	—
ECN NO.	REV.	DATE.	DESCRIPTION.	CHANGE.	CHECK.	APPRO.